



Sprinkler thinker®

Battery Powered Electronic Controller

OWNERS MANUAL

3006 – Deluxe Programmable Three Station 3613 – Valve Adaptor for 3006

INTRODUCTION

THANK YOU for purchasing DIG Battery Powered Electronic Controller.

Please take the time to read through the enclosed instructions and follow them step by step. If you have any questions, please call our customer service line 1-800-344-2281.

Once installed your DIG Controller will give you years of dependable worry-free operation.

CHOOSING THE PROPER ADAPTOR UNIT MODEL 3006 AND 3613

Your DIG Controller comes factory assembled to fit 3/4" Champion and Orbit manual brass valves. Included in the package, you will find adaptors to fit 1" Champion, Orbit manual brass valves, 3/4" and 1" Rainbird, Rainjet Lawngenie manual plastic valves, and 3/4" and 1" Lawngenie and Orbit plastic valves.

NOTE: Please select proper adaptor.

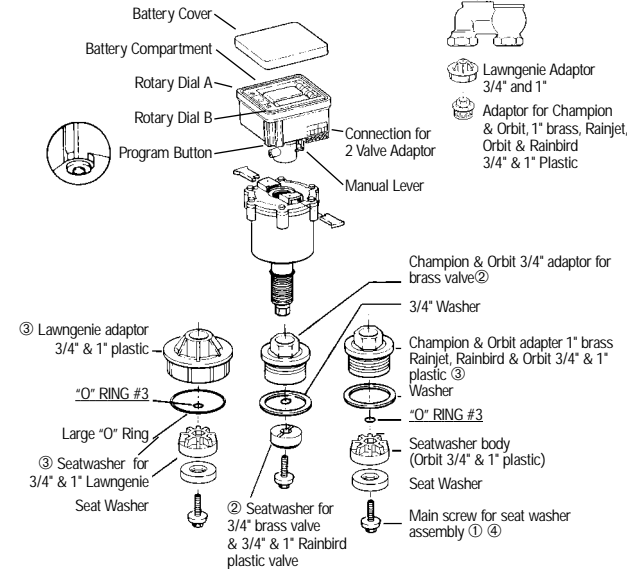

ASSEMBLE PROPER ADAPTOR (IF REQUIRED)

- Remove main screw with a pair of pliers by turning counter clockwise.
- Remove 3/4" seatwasher and then 3/4" adaptor, by turning counter clockwise and pulling away.
- Replace with proper adaptor and seatwasher. Make sure #3 "O" ring is in place.
- Replace main screw. Tighten firmly, but do not overtighten.

NOTE: Take care not to lose #3 "O" ring.

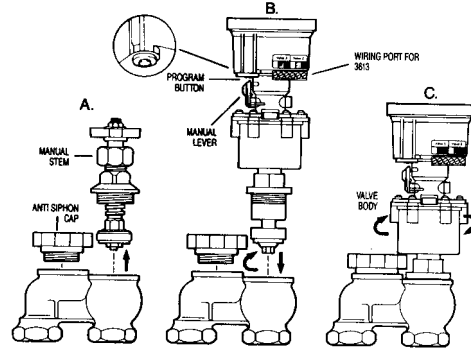

INSTALLATION OF CONTROLLER AND ADAPTOR UNIT MODEL 3006 AND 3613

- Shut off your water supply.
 - Remove the manual stem from your existing valve. If you are converting an antisiphon valve, temporarily remove the antisiphon cap (see A).
 - Replace any existing worn washers with the new ones provided.
 - Install controller or valve adaptor into valve (see B) using a wrench, tighten firmly, but do not overtighten.
 - Rotate valve body clockwise until completely closed (see C).
 - Turn on main water supply.
 - Turn manual lever to "on" position (left).
 - Now rotate valve body counter clockwise until all sprinklers/sprayers are working evenly.
 - Turn manual lever from "on" to auto position (center). Water will stop.
- NOTE: If water continues to flow, turn valve body slowly clockwise 1/4 turn. Repeat steps 7-9 if necessary.**

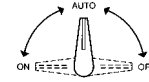

CONNECTING 3613 VALVE ADAPTOR

For model 3613 valve adaptor, connect the 3 strand wire according to the color code on the 3006 controller. We recommend that you connect the wires ONLY after you have completed your installation.

NOTE: Model 3006 three station controller must only be used with model 3613 valve adaptor.

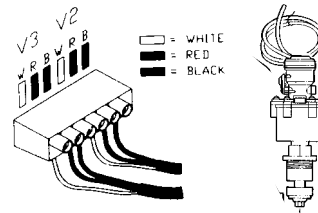

PROGRAMMING MODEL 3006

NOTE: The 3006 can be used to control 1, 2 or 3 valves. While in the process of programming, only valve #1 will open and close, even when programming valves #2 and #3.

There are three basic steps required to program your 3006. Duration, Start Time and Frequency. These steps must be followed in order: 1) Duration, 2) Start Time and 3) Watering Frequency.

Insert two fully charged 9 volt alkaline batteries (Note + and - symbols). (Rotary dials located in battery compartment must be on 0, wait for 30 seconds to charge.)

Check Table A for the availability of your desired watering duration for all your valves. If they appear follow A. If they do not, customize your watering durations by following B. Choose either A or B for all valves.

Table A – DURATION – 15 PRESET WATERING PROGRAMS					
PROGRAM #	DURATION	PROGRAM #	DURATION	PROGRAM #	DURATION
1	5 Minutes	6	1 Hour	B	5 Hours
2	10 Minutes	7	1.5 Hours	C	6 Hours
3	20 Minutes	8	2 Hours	D	9 Hours
4	30 Minutes	9	3 Hours	E	10 Hours
5	45 Minutes	A	4 Hours	F	12 Hours

Step 1 – Watering Duration

A. Using one of 15 preset watering programs

- With orange screwdriver, included, set dial B to number 1.
- Set dial A to program number (Table A).
- Press and hold the program button. You will hear a click and the valve will turn on. Continue holding the button until you hear three more clicks (this occurs after eight seconds). These clicks indicate that the program has been accepted.
To program valve #2, set dial B to #2 and follow steps 2 & 3. The same procedure is used for valve #3.
- Now you can set your start time.

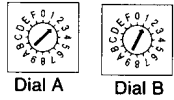

B. Using your own desired watering duration

- Setting the duration for your first valve:
- Set dial A to number 1.
 - Set dial B to 0.
 - Press the button once, you will hear a click and the valve will turn on.
 - Wait the amount of time you wish to water and push and release the button again, the valve will shut.

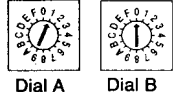

Now set the duration for valve 2, switch dial A to number 2 and proceed with steps 3 and 4. To set valve 3, switch dial A to number 3 and do the same.

- Set dial A to 0.
- Set dial B to number 1.
- Press and hold the program button. You will hear a click and the water will turn on. Continue holding the button until you hear three clicks (this occurs after eight seconds). These clicks indicate that the program has been accepted.
- Leaving dial A on 0, set dial B to number 2 and follow step 3, then switch dial B to number 3 and do the same.
- Duration of watering has now been set for all valves, now you can set your start time.

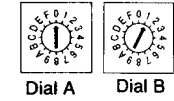

NOTE: To change duration of watering for any or all valves, you must remove the batteries for 30 seconds and re-program.

Step 2 – Start time

To program your start time you must choose one of two options: **A. Real Time Watering** (you must push the button at the actual time you want the cycle to begin) or **B. 12 Hour Delayed Watering**, allowing you to program 12 hours in advance of your desired start time. Example of 12 Hour Delayed Watering: Performing programming at 4 pm for a cycle you desired to begin at 4 am.

NOTE: Start time indicates when valve #1 will open. Valves #2 and #3 will follow sequentially.

A. Real Time Watering

- Set both dials to 0.
- At the time of day you wish to start watering, push and release the button. You will hear a click and valve #1 will open and run its cycle. Valves #2 and #3 will follow.
- Now you can set your watering frequency (Table B).

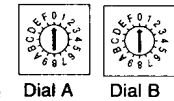

B. 12 Hour Delayed Watering

- Programming to be done 12 hours in advance of the actual desired start time.
- Set dial A to F.
 - Set dial B to 0.
 - Push the program button momentarily and release. You will hear a click and valve #1 will open and run its cycle. Valves #2 and #3 will follow.
 - Now you can set your watering frequency (Table B).
 - Your first regular cycle will begin 12 hours after inputting your start time.

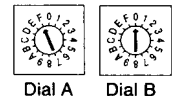

NOTE: If you do NOT wish to have all three valves run through their cycles at the time of programming, press the button again to cancel this cycle. Your program will begin 12 hours later.

HELPFUL HINTS & ADDITIONAL INFORMATION

- You may get a manual cycle at any time by pressing the program button once. Your valve(s) will operate one time for the length of time you have programmed and then go back to the normal program.
- To change complete program, remove batteries for 30 seconds. On Model 3006, return dials to 0, replace batteries and reprogram.
- You may change the watering frequency by turning dial B at any time without disturbing your start time or duration programs.
- If you are not using your DIG controller for long periods of time, remove batteries and replace cover securely. When you replace batteries, you will have to reprogram.
- All DIG controllers can be programmed in the comfort of your home or office and installed at a later date. No water pressure is required.
- At any time you can shut your valve by turning the manual lever to the off position. This does not interfere with your program. To return to normal program, turn manual lever to the center auto position.
- At any time you can turn your valve on by turning the manual lever to the on position. This does not interfere with your program. To return to normal program, turn manual lever to the center auto position.
- Always make sure that the battery compartment is clean and dry. If water should get on the batteries, immediately remove and wipe clean. **KEEP BATTERY COMPARTMENT SECURELY CLOSED AT ALL TIMES.**
- We strongly recommend brand name alkaline batteries such as Duracell or Eveready. Rechargeable batteries are not recommended.
- Battery life in DIG controllers is rated one to two years. As a reminder, tape the date of installation to the batteries.
- Remove timer and store indoors when temperature is below 32°.

TROUBLESHOOTING AND MAINTENANCE

What to do if:

- Controller does not respond to programming.
 - Batteries are dead or improperly installed.
 - Manual lever is not set on auto (center) position.
 - Dial was not on 0 when beginning programming.
- Valve fails to open.
 - Manual lever is in closed position.
 - Batteries are dead.
 - Valve body is turned too far clockwise.
 - Check main screw for seat washer, remove and clean the orifice.
- Valve fails to close.
 - Manual lever is in open position.
 - Valve body is turned too far counter clockwise.
 - Check seatwasher at base of valve.
 - Check screw for seatwasher, remove and clean the orifice.

Step 3 – Watering Frequency

- Select desired watering frequency from table B and set dial B to the desired position.

DIAL B POSITION	TIME BETWEEN WATERING	DIAL B POSITION	TIME BETWEEN WATERING
1	Flow occurs once every 45 min	9	Flow occurs once every 4 days
2	Flow occurs once every 15 hours	A	Flow occurs once every 5 days
3	Flow occurs once every 3 hours	B	Flow occurs once every 6 days
4	Flow occurs once every 6 hours	C	Flow occurs once every 7 days
5	Flow occurs once every 12 hours	D	Flow occurs once every 10 days
6	Flow occurs once every 1 day	E	Flow occurs once every 14 days
7	Flow occurs once every 2 days	F	Flow occurs once every 21 days
8	Flow occurs once every 3 days		

YOUR CONTROLLER IS NOW PROGRAMMED.

To change watering frequency, simply turn dial B to new position.

NOTE: We recommend making sure your batteries are fully charged before leaving the controller unattended for long periods.

NOTE: If you have any problems with the 3613, always check 3 wire connector first.

Quick Simple Once A Day Program

Set rotary switch A and B to 0. Press the program button momentarily at the time of day you wish to water. You will hear a click. The valve will open for 10 minutes per valve, once every 24 hours.

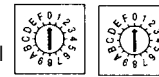

Dial A Dial B

Make sure that the cover is tightened firmly in place to prevent water damage.

NOTE: We recommend an annual application of water repellent silicone or WD-40 to the battery contacts.

EXAMPLE OF PROGRAM FOR 3 VALVES

Program of valves 1-2 for 10 minutes and valve 3 for 20 minutes, start time at 6 am every 2 days

Step 1 – Duration

- Set dial A to program #2 (10 minutes) (see Table A).
- Set dial B to #1 (valve 1).
- Press and hold the program button. You will hear a click. Continue holding the button for 8 seconds until you hear three more clicks. These clicks indicate that the program has been accepted for valve #1.
- For valve 2 set dial B to 2 and press the button again. Hold for 8 seconds. You will hear three more clicks indicating that the program has been accepted for valve #2.
- For valve 3 set dial B to #3 and dial A to #3 (20 minutes). Press and hold the program button. You will hear a click. Continue holding the button until you hear three more clicks indicating that the program for valve #3 has been accepted.

Step 2 – Start Time

- Set both dials to #0 at 6 am. Push the button and release. You will hear a click indicating that valve #1 is open and start time has been accepted.

Step 3 – Watering Frequency

- Set dial B to #7 (see Table B). Your controller will turn on every 2 days for 10 minutes for valve #1 and #2 and 20 minutes for #3 with start time at 6 am.

DIG CORPORATION 3 YEAR WARRANTY

DIG CORPORATION warrants these products to be free from defects in material and workmanship for a period of three years from date of purchase. This warranty does not cover damage resulting from accident, misuse, neglect, modification, improper installation or subsection to line pressure in excess of 150 lbs. per square inch. This warranty shall extend only to the original purchaser of the product for use by the purchaser. This warranty shall not cover batteries or any malfunction of the product due to battery failure. The obligation of DIG CORPORATION under this warranty is limited to repairing or replacing at its factory this product which shall be returned to the factory within three years after the original purchase and which on examination is found to contain defects in material and workmanship.

DIG CORPORATION SHALL IN NO EVENT BE LIABLE FOR ANY INCIDENTAL OR CONSEQUENTIAL DAMAGES OF ANY KIND. THE SOLE OBLIGATION OF DIG BEING LIMITED TO REPAIR OR REPLACEMENT OF DEFECTIVE PRODUCTS. SOME STATES DO NOT ALLOW THE EXCLUSION OR LIMITATION OF INCIDENTAL OR CONSEQUENTIAL DAMAGES, SO THE ABOVE LIMITATION OR EXCLUSION MAY NOT APPLY TO YOU.

Unattended use for prolonged periods without inspection to verify proper operation is beyond the intended use of this product, and any damage resulting from such use shall not be the responsibility of DIG CORPORATION. There are no warranties which extend beyond the description on the face hereof. In the case of purchase of the product for use other than, for irrigation purposes, DIG CORPORATION hereby disclaims any implied warranties including any warranties of merchantability and fitness for a particular purpose. In the case of the purchase of the product for personal, family or household purposes, DIG CORPORATION disclaims any such warranties to the extent permitted by law. To the extent that any such disclaimer or implied warranties shall be ineffectual, then any implied warranties shall be limited in duration to a period of one year from the date of the original purchase for use by the purchaser. Some states do not allow limitation on how long an implied warranty lasts, so the above limitation may not apply to you.

In order to obtain performance under this warranty, the unit must be returned to the factory, along with proof of purchase indicating original date of purchase, shipping prepaid, addressed as follows: DIG CORPORATION, 1210 Activity Drive, Vista, CA 92083. Repaired or replaced units will be shipped prepaid to the name and address supplied with the unit returned under warranty. Allow four weeks for repairs and shipping time. Repair of damaged units not otherwise within warranty may be refused or done at a reasonable cost or charge at the option of DIG CORPORATION.

This warranty gives you specific legal rights, and you may also have other rights which vary from state to state.

PARTS LIST

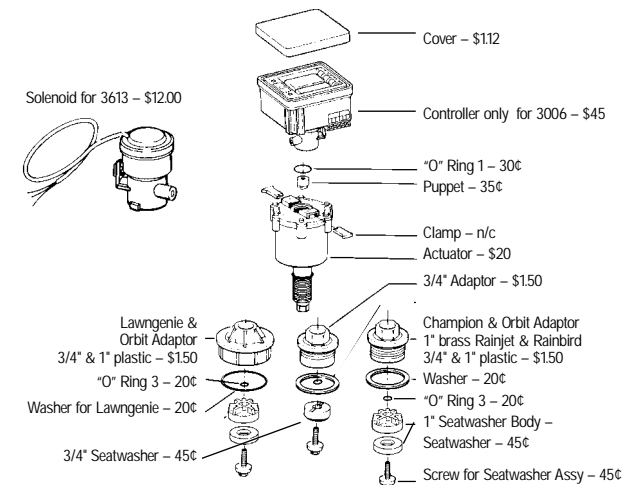

TO ORDER PARTS:

1-800-344-2281 FAX: 760-727-0282

We at DIG Corporation understand that most dealers do not carry spare parts. For your convenience, if you need one of these parts, order here. Parts will be sent within 15 days. For faster service, you may call DIG's customer service number 1-800-322-9146 and parts can be shipped immediately. All phone orders will have an added C.O.D. charge. Make checks payable to Dig Corporation.

Choose correct part and circle. Add total dollar value \$ _____

Add \$5.00 for shipping and handling \$ 5.00 _____

California residents add sales tax \$ _____

TOTAL \$ _____



1210 Activity Drive, Vista, CA 92083
800-322-9146
www.digcorp.com
email: dig@digcorp.com



Form 26-011