

INTRODUCTION

THANK YOU for purchasing DIG Battery Powered Electronic Controller.

Please take the time to read through the enclosed instructions and follow them step by step. If you have any questions, please call our customer service line (619) 727-0919.

Once installed your DIG Controller will give you years of dependable worry-free operation.

ASSEMBLE PROPER ADAPTOR CONTROL UNIT MODEL 2001, 2006

Your DIG Controller comes factory assembled to fit 3/4" Champion and Orbit manual brass valves. Included in the package, you will find adaptors to fit 1" Champion, Orbit manual brass valves, 3/4" and 1" Rainbird, Rainjet manual plastic valves, and 3/4" and 1" Richdel and Orbit plastic valves.

NOTE: Please select proper adaptor.

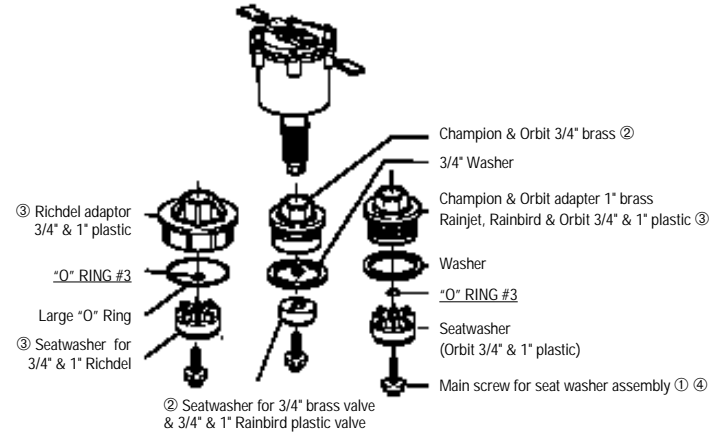
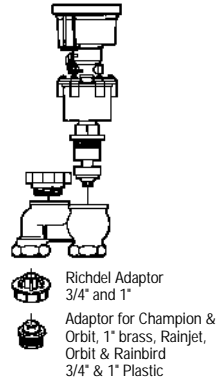

ASSEMBLE PROPER ADAPTOR (IF REQUIRED)

- Remove main screw with a pair of pliers by turning counter clockwise.
- Remove 3/4" seatwasher and then 3/4" adaptor, by turning counter clockwise and pulling away.
- Replace with proper adaptor and seatwasher. Make sure #3 "O" ring is in place.
- Replace main screw. Tighten firmly, but do not overtighten.

NOTE: Take care not to lose #3 "O" ring.

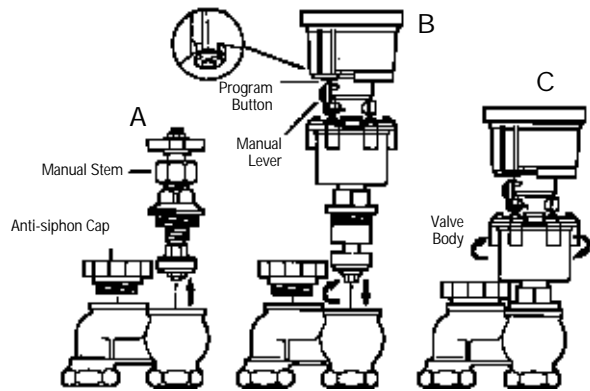

INSTALLATION OF CONTROLLER UNIT MODEL 2001-2006

- Shut off your water supply.
- Remove the manual stem from your existing valve. If you are converting an antisiphon valve, temporarily remove the antisiphon cap (see A).
- Replace any existing worn washers with the new ones provided.
- Install controller or valve adaptor into valve (see B) using a wrench, tighten firmly, but do not overtighten.
- Rotate valve body clockwise until completely closed (see C).
- Turn on main water supply.

NOTE: We recommend an annual application of water repellent silicone or WD-40 to the battery contacts.



- Turn manual lever to "on" position left.
- Now rotate valve body counter clockwise until valve is operational.
- Turn manual lever from "on" to auto position (center). Water will stop.

NOTE: If water continues to flow, turn valve body slowly clockwise 1/4 turn. Repeat steps 7-9 if necessary.

YOUR CONTROLLER MODEL 2001 or 2006 HAS NOW BEEN INSTALLED, PLEASE GO ON TO PROGRAMMING.

PROGRAMMING MODELS 2001-2006

- Insert two fully charged 9 volt alkaline batteries (Note + and - symbols). On Model 2006 rotary dial (located in battery compartment) must be on 0, wait for 30 seconds to change the program.
 - At the time of day that you would like to start water, press the button once. You will hear a click and the valve will turn on.
 - Leave the system on for desired duration, then press the same button. You will hear another click and the valve will shut. **You have now programmed the start time and duration of watering.**
- NOTE:** If you installed model 2001, you have completed the programming. Your 2001 will operate automatically once a day only. If you installed model 2006 please continue.
- After you have programmed your start and stop time, choose the water flow frequency by turning the dial with the orange screwdriver to selected position.

WATERING FREQUENCY TABLE			
DIAL POSITION	TIME BETWEEN WATERING	DIAL POSITION	TIME BETWEEN WATERING
0	Programming (only used when setting length of watering).	8	Flow occurs once every 3 days
1	Flow occurs once every 45 min.	9	Flow occurs once every 4 days
2	Flow occurs once every 1.5 hours	A	Flow occurs once every 5 days
3	Flow occurs once every 3 hours	B	Flow occurs once every 6 days
4	Flow occurs once every 6 hours	C	Flow occurs once every 7 days
5	Flow occurs once every 12 hours	D	Flow occurs once every 10 days
6	Flow occurs once every day	E	Flow occurs once every 14 days
7	Flow occurs once every 2 days	F	Flow occurs once every 21 days

Make sure that the cover is tightened firmly in place to prevent water damage.

YOUR CONTROLLER IS NOW PROGRAMMED.

To change watering frequency, simply turn dial to new position.

PROGRAMMING - MODEL 306

NOTE: The 904 can be used to control 1 valve with pool level sensor. Insert two fully charged 9-Volt Alkaline batteries (note + and - symbols).

The three basic steps required to program your 904 are Duration, Start Time and Frequency. These steps must be followed in order.

DURATION

CHECK TABLE "A" FOR THE AVAILABILITY OF YOUR DESIRED LENGTH OF WATERING FOR ALL YOUR VALVES. IF THEY APPEAR FOLLOW A.

IF THEY DO NOT, CUSTOMIZE YOUR WATER FLOW DURATIONS BY FOLLOWING B.

CHOOSE EITHER "A" OR "B" FOR YOUR VALVE.

A. USING ONE OF 15 PRESET WATER FLOW DURATIONS

- With orange screwdriver, set dial B to number 1.
- Set dial A to selected program number (Table A).
- Press and hold the program button. You will hear a click and the water will turn on. Continue holding the button until you hear three more clicks (this occurs after eight seconds). These clicks indicate that the program has been accepted.
- Now you can set your start time



Here is an example of Valve #1 set for 5 minutes.

Table A - 15 POOL & SPA PRESET WATER FLOW PROGRAMS					
1	5 MINUTES	6	1 HOUR	B	5 HOURS
2	10 MINUTES	7	1.5 HOURS	C	6 HOURS
3	20 MINUTES	8	2 HOURS	D	9 HOURS
4	30 MINUTES	9	3 HOURS	E	10 HOURS
5	45 MINUTES	A	4 HOURS	F	12 HOURS

START TIME

To program your start time you must choose one of two options: 1. Real Time Watering (you must push the button at the actual time you want the

cycle to begin) or 2. 12 Hour Delayed Water Flow, allowing you to program 12 hours in advance of your desired start time. Example of 12 Hour Delayed Water Flow: Performing programming at 4 pm for a cycle you desired to begin at 4 am.

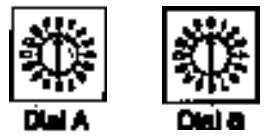

REAL TIME WATER FLOW

- Set both dials to 0
- At the time of day you wish to start water flow, push and release the button. You will hear a click and valve will open and run its cycle.

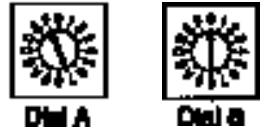

12 HOUR DELAYED MONITORING

Programming to be done 12 hours in advance of the actual desired start time.

- Set Dial A to "F".
- Set Dial B to 0.
- Push the program button momentarily and release. You will hear a click and valve will open and run its cycle.
- Your first regular cycle will begin 12 hours after inputting your start time.

NOTE: If you do NOT wish to have your valve run through the cycle at the time of programming, press the button again to cancel this cycle. Your program will begin 12 hours later.

POOL AND SPA FLOW FREQUENCY

- Select desired flow frequency from table B and set dial B.

Table B - POOL & SPA FLOW FREQUENCY TABLE			
DIAL POSITION	TIME BETWEEN WATER FLOW	DIAL POSITION	TIME BETWEEN WATER FLOW
1	Flow will occur once every 45 min.	9	Flow will occur once every 4 days
2	Flow will occur once every 1.5 hours	A	Flow will occur once every 5 days
3	Flow will occur once every 3 hours	B	Flow will occur once every 6 days
4	Flow will occur once every 6 hours	C	Flow will occur once every 7 days
5	Flow will occur once every 12 hours	D	Flow will occur once every 10 days
6	Flow will occur once every 1 day	E	Flow will occur once every 14 days
7	Flow will occur once every 2 days	F	Flow will occur once every 21 days
8	Flow will occur once every 3 days		

NOTE: To change water flow frequency, simply turn dial B.

QUICK SIMPLE ONCE A DAY PROGRAM

Set rotary switch "A" and "B" to "0". Press the program button momentarily at the time of day you wish to fill your pool or spa. You will hear a click. The valve will open for 10 minutes per valve, once every 24 hours.



B. USING YOUR OWN DESIRED WATER FLOW DURATION

Setting the duration for your valve.

- Set dial A to number 1.
- Set dial B to 0.
- Press the button once, you will hear a click and the valve will turn on.
- Wait the amount of time you wish to monitor (up to 23 hr, 59 min) and push and release the button again, the valve will shut.



NOW TO PROGRAM:

- Set dial A to 0.
- Set dial B to number 1.
- Press and hold the program button. You will hear a click and the water will turn on. Continue holding the button until you hear three clicks (this occurs after eight seconds). These clicks indicate that the program has been accepted.
- Now you can set your start time.

NOTE: To change water flow duration, you must remove the batteries for 30 seconds and reprogram.

HELPFUL HINTS AND ADDITIONAL INFORMATION

- You may get a manual cycle at any time by pressing the program button once. Your valve(s) will operate one time for the length of time you have programmed and then go back to the normal program.
- To change complete program, remove batteries for 30 seconds. On Model 2006, return dial to 0, replace batteries and reprogram.

3. You may change the watering frequency by turning the dial at any time without disturbing your start time or duration programs.
4. If you are not using your DIG controller for long periods of time, remove batteries and replace cover securely. When you replace batteries, you will have to reprogram.
5. All DIG controllers can be programmed in the comfort of your home or office and installed at a later date. No water pressure is required.
6. At any time you can shut your valve by turning the manual lever to the off position. This does not interfere with your program. To return to normal program, turn manual lever to the center auto position.
7. At any time you can turn your valve on by turning the manual lever to the on position. This does not interfere with your program. To return to normal program, turn manual lever to the center auto position.
8. Always make sure that the battery compartment is clean and dry. If water should get on the batteries, immediately remove and wipe clean. **KEEP BATTERY COMPARTMENT SECURELY CLOSED AT ALL TIMES.**
9. We strongly recommend brand name batteries such as Duracell or Eveready. Rechargeable batteries are not recommended.
10. Battery life in DIG controllers is rated up to two years. As a reminder, tape to the batteries, the date of installation.
11. DIG has a built in fail safe system. When battery power gets too low the controller will immediately shut the valve.
12. Remove timer and store indoors when temperature is below 32°.

TROUBLESHOOTING AND MAINTENANCE – What to do if:

1. Controller does not respond to programming.
 - A. Batteries are dead or improperly installed.
 - B. Manual lever is not set on auto (center) position.
 - C. Dial was not on 0 when beginning programming.
2. Valve fails to open.
 - A. Manual lever is in closed position.
 - B. Batteries are dead.
 - C. Valve body is turned too far clockwise (for models 2001-2006).
 - D. Check main screw for seat washer, remove and clean the orifice (for models 2001-2006).
3. Valve fails to close.
 - A. Manual lever is in open position.
 - B. Valve body is turned to far counter clockwise (2001-2006).
 - C. Check seatwasher at base of valve (for models 2001-2006).
 - D. Check screw for seatwasher, remove and clean the orifice (for models 2001-2006).

PARTS LIST

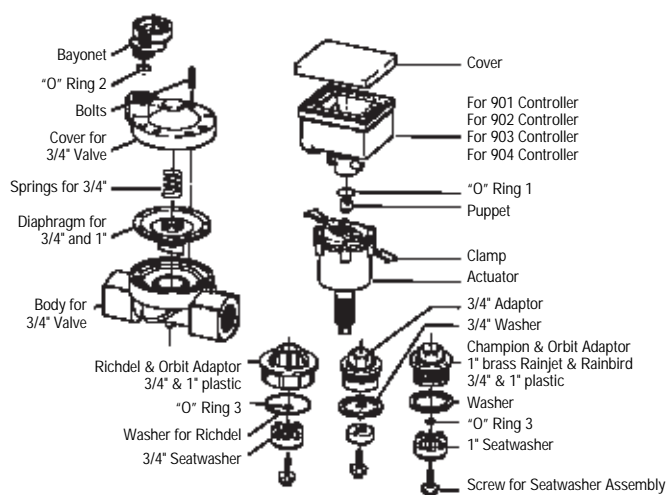

BATTERY POWERED ELECTRONIC CONTROLLER

Owners Manual

2001
Once-A-Day Single Station

2006
Deluxe Programmable Single Station

DIG CORPORATION 1 YEAR WARRANTY

DIG CORPORATION warrants these products to be free from defects in material and workmanship for a period of one year from date of purchase. This warranty does not cover damage resulting from accident, misuse, neglect, modification, improper installation or subjection to line pressure in excess of 150 lbs. per square inch. This warranty shall extend only to the original purchaser of the product for use by the purchaser. This warranty shall not cover batteries or any malfunction of the product due to battery failure. The obligation of DIG CORPORATION under this warranty is limited to repairing or replacing at its factory this product which shall be returned to the factory within one year after the original purchase and which on examination is found to contain defects in material and workmanship.

DIG CORPORATION SHALL IN NO EVENT BE LIABLE FOR ANY INCIDENTAL OR CONSEQUENTIAL DAMAGES OF ANY KIND; THE SOLE OBLIGATION OF A&B BEING LIMITED TO REPAIR OR REPLACEMENT OF DEFECTIVE PRODUCTS. SOME STATES DO NOT ALLOW THE EXCLUSION OR LIMITATION OF INCIDENTAL OR CONSEQUENTIAL DAMAGES, SO THE ABOVE LIMITATION OR EXCLUSION MAY NOT APPLY TO YOU.

Unattended use for prolonged periods without inspection to verify proper operation is beyond the intended use of this product, and any damage resulting from such use shall not be the responsibility of DIG CORPORATION. There are no warranties which extend beyond the description on the face hereof. In the case of purchase of the product for use other than, for irrigation purposes, DIG CORPORATION hereby disclaims any implied warranties including any warranties of merchantability and fitness for a particular purpose. In the case of the purchase of the product for personal, family or household purposes, DIG CORPORATION disclaims any such warranties to the extent permitted by law. To the extent that any such disclaimer or implied warranties shall be ineffectual, then any implied warranties shall be limited in duration to a period of one year from the date of the original purchase for use by the purchaser. Some states do not allow limitation on how long an implied warranty lasts, so the above limitation may not apply to you.

In order to obtain performance under this warranty, the unit must be returned to the factory, along with proof of purchase indicating original date of purchase, shipping prepaid, addressed as follows:

DIG CORPORATION, 130 Bosstick Blvd., San Marcos, CA 92069. Repaired or replaced units will be shipped prepaid to the name and address supplied with the unit returned under warranty. Allow four weeks for repairs and shipping time. Repair of damaged units not otherwise within warranty may be refused or done at a reasonable cost or charge at the option of DIG CORPORATION.

This warranty gives you specific legal rights, and you may also have other rights which vary from state to state.

TO ORDER PARTS CALL: 619-322-4718 FAX: 619-322-4719

**A & B POOL PRODUCTS INTERNATIONAL, INC.
121 SOUTH PALM CANYON DRIVE, SUITE #207
PALM SPRINGS, CALIFORNIA 92262**